

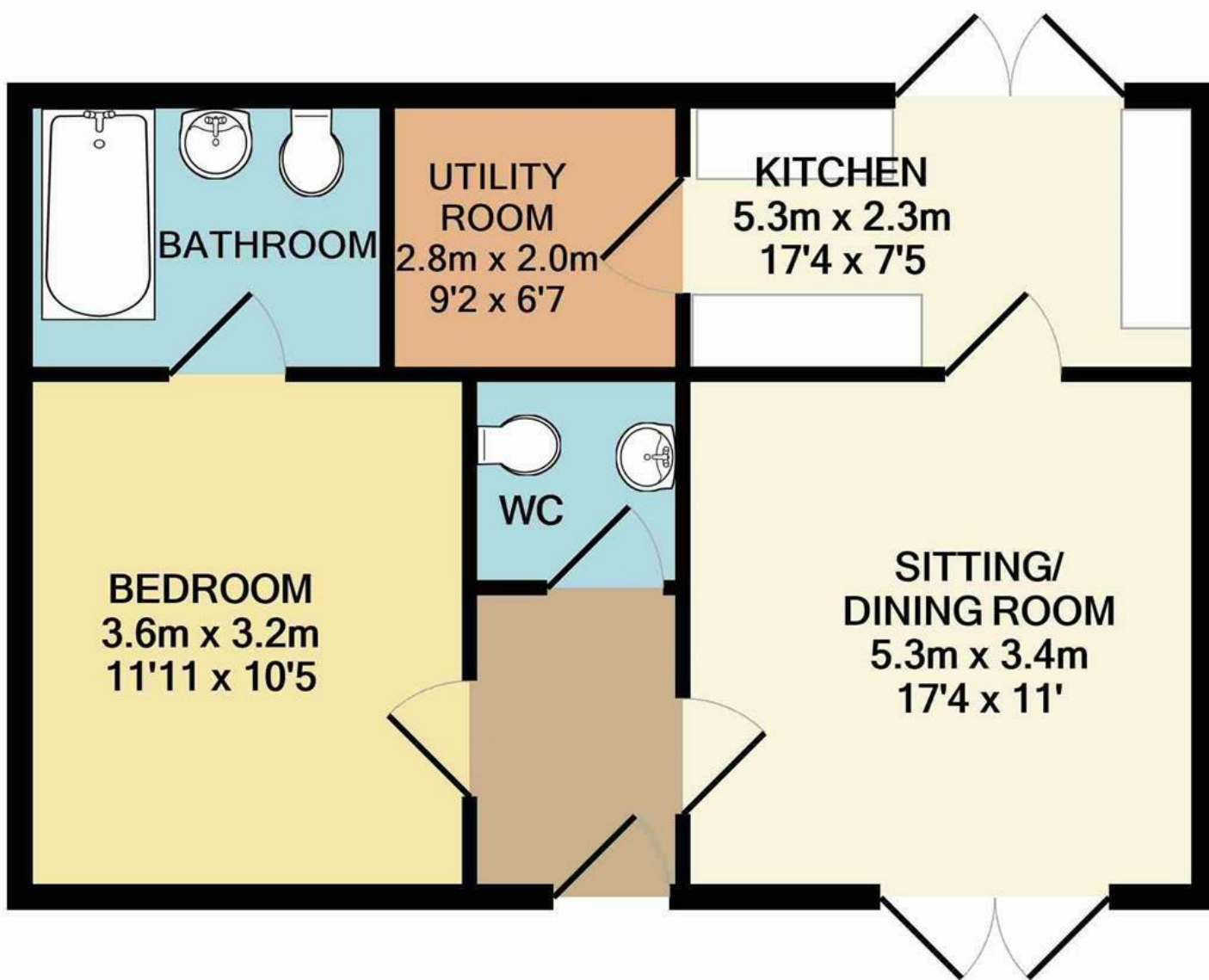

Coast Road | Norwich | NR12  
 Guide Price £150,000

abbotFox



Energy Efficiency Rating		
	Current	Potential
Very energy efficient - lower running costs		
(92 plus) <b>A</b>		
(81-91) <b>B</b>		
(69-80) <b>C</b>		
(55-68) <b>D</b>		
(39-54) <b>E</b>		
(21-38) <b>F</b>		
(1-20) <b>G</b>		
Not energy efficient - higher running costs		
<b>England &amp; Wales</b>		EU Directive 2002/91/EC

Disclaimer – In accordance with the Property Misdescriptions Act, the company gives notice that all descriptions, references to condition, necessary permissions for use and other details are given in good faith and believed to be correct, but any intending lessees do not rely on them as statements of fact, but must satisfy themselves by inspection or other means, as to their accuracy.

Whilst every attempt has been made to ensure the accuracy of the floor plan contained here, measurements of doors, windows, rooms and any other items are approximate and no responsibility is taken for any error, omission, or mis-statement. This plan is for illustrative purposes only and should be used as such by any prospective purchaser. The services, systems and appliances shown have not been tested and no guarantee as to their operability or efficiency can be given  
 Made with Metropix ©2021



abbotFox present this one bedroom ground floor apartment located in the popular and well-served coastal village of Bacton. Internal accommodation offering entrance hall, double bedroom with en suite shower room, WC, generous lounge, large kitchen diner and utility. With external space benefiting from a front and rear patio garden, as well as shingle drive and off-street parking. The property is ideally suited to anyone downsizing, or searching for a holiday home or second home.

Bacton is a small village on the coast with a sandy beach and is situated in an unspoilt area of open countryside about 18 miles to the north of Norwich. As well as a the beach Bacton offers a couple of local stores, a pub, cafes and takeaways.

Guide price £150,000-£160,000

